

1 MEZZANINE LEVEL FLS PLAN
3/32" = 1'-0"

72" EXIT WIDTH @
0.15" PER OCC =
480 MAX OCCUPANTS

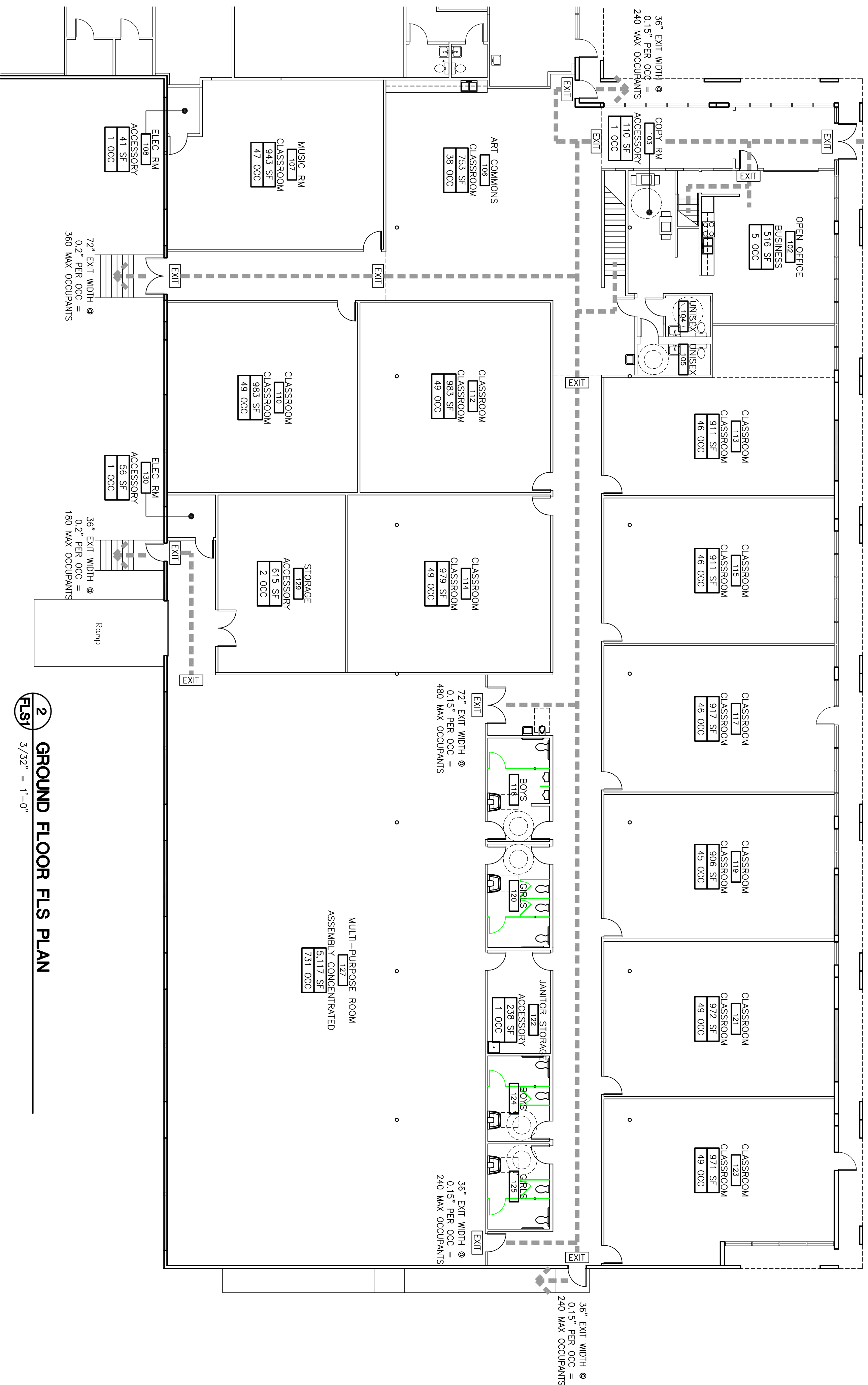

2 GROUND FLOOR FLS PLAN
3/32" = 1'-0"

LEGEND

- EGRESS PATH
- EXIT INDICATES EXIT SIGN LOCATION, ARROW INDICATES DIRECTION
- OCCUPANT LOAD KEY:
 - MERCANTILE <---> OCCUPANT LOAD TYPE
 - 2,131 SF <---> ROOM AREA
 - 71 OCC <---> NUMBER OF OCCUPANTS

CODE SUMMARY

2007 O.S.C. BASED ON 2006 INTERNATIONAL BUILDING CODE	III-B, FULLY SPRINKLERED
CONSTRUCTION TYPE	GROUP E (EDUCATIONAL)
MAIN OCCUPANCY GROUP	GROUP B (BUSINESS)
ACCESSORY OCCUPANCY GROUPS	GROUP S-2 (LOW HAZARD STORAGE)
	GROUP A-3 (ASSEMBLY FOR RECREATION), NOT CONSIDERED ACCESSORY BASED ON SECTION 508.3.1 EXCEPTION 2
OCCUPANCY SEPARATION (TABLE 508.3.3)	
1-HOUR SEPARATION REQUIRED BETWEEN B AND A, E & S-2. AUTOMATIC SPRINKLER SYSTEM PROVIDED IN LEU OF 1-HOUR RATING SEPARATION	
BUILDING HEIGHT & AREA	
BASIC ALLOWABLE AREA PER TABLE 503	GROUP E 14,500 SF
YARD SEPARATION OVER 30 FEET	4 SIDES
FRONTAGE INCREASE (SECTION 506.2)	IF = 100 (F/P - 0.25) W/30
	IF = 100 [905/905-0.25]30/30
	IF = 75
FIRE PROTECTION INCREASE (SECTION 506.3) IS = 300	
AREA MODIFICATIONS (SECTION 506.1)	A ₀ = A + (A ₁ X IF/100) + (A ₂ X IS/100)
	A ₀ = 14,500 + (14,500 X 75/100) + (14,500 X 300/100)
	A ₀ = 64,975 SF MAX ALLOWABLE
ACTUAL BUILDING AREA	GROUND FLOOR 21,253 SF
	MEZZANINE 1,927 SF
	TOTAL 23,180 SF
BASIC ALLOWABLE HEIGHT PER TABLE 503	GROUP E 2 STORIES / 55 FEET
BUILDING HEIGHT MODIFICATIONS	3 STORIES / 75 FEET (PER SECTION 504.2)
ACTUAL BUILDING HEIGHT	1 STORY, 7? FEET
MEZZANINE AREA LIMITATIONS (SECTION 505.2) - SHALL NOT EXCEED 7085 SF (1/3 OF SPACE IN WHICH MEZZANINE IS LOCATED), ACTUAL MEZZANINE 1,927 SF	
MEZZANINE EGRESS (SECTION 505.3) - TWO MEANS OF EGRESS PROVIDED WHERE THE COMMON PATH OF EGRESS DOES NOT EXCEED 100 FT. THE MAXIMUM TRAVEL DISTANCE DOES NOT EXCEED 400 FT FOR S OCCUPANCIES WITH A SPRINKLER SYSTEM AND THE REQUIRED EXIT SEPARATION IS PROVIDED (SEE 1/F/L1)	
MEZZANINE OPENNESS (SECTION 505.4) - MEZZANINE NOT REQUIRED TO BE OPEN TO THE ROOM IN WHICH THE MEZZANINE IS LOCATED BASED ON EXCEPTION 1, MAX OCCUPANT LOAD IS 6 OCCUPANTS	
BUILDING COMPONENT REQUIREMENTS (TABLE 601)	
TYPE III-B CONSTRUCTION	
STRUCTURAL FRAME	2
EXTERIOR BEARING WALLS	0
INTERIOR BEARING WALLS	0 FOR X ≥ 30
EXTERIOR NONBEARING (TABLE 602)	0
INTERIOR NON BEARING WALLS	0
FLOOR CONSTRUCTION	0
ROOF CONSTRUCTION	0
MEANS OF EGRESS	
OCCUPANT LOAD FACTORS (TABLE 1004.1.1)	1 OCC/300 SF
ACCESSORY STORAGE AREAS,	1 OCC/17 SF
MECHANICAL EQUIPMENT ROOM	1 OCC/100 SF
ASSEMBLY CONCENTRATED	1 OCC/20 SF
BUSINESS AREAS	
EDUCATIONAL CLASSROOM AREA	
EGRESS COMPONENTS (STAIRS, CORRIDORS, ETC.) & TOILET FACILITIES DO NOT CONTRIBUTE TO BUILDING OCCUPANCY	
TOTAL BUILDING OCCUPANT LOAD	1,261 OCCUPANTS
EGRESS WIDTH (TABLE 1005.1)	E OCCUPANT WITH A SPRINKLER SYSTEM
STAIRWAYS	0.20 INCHES PER OCCUPANT
OTHER EGRESS COMPONENTS	0.15 INCHES PER OCCUPANT
EXIT ACCESS TRAVEL DISTANCE (TABLE 1016.1)	
OCCUPANCY A/E	250 FT WITH SPRINKLER SYSTEM
OCCUPANCY B	300 FT WITH SPRINKLER SYSTEM
OCCUPANCY S-2	400 FT WITH SPRINKLER SYSTEM
CORRIDORS FIRE-RESISTANCE RATING (TABLE 1017.1)	0 HRS WITH SPRINKLER SYSTEM
MINIMUM NUMBER OF EXITS FOR OCCUPANT LOAD (TABLE 1019.1)	4 EXITS REQUIRED; 4 EXITS PROVIDED
MORE THAN 1,000 OCCUPANTS	
ASSEMBLY (OSCC 1025)	
MINIMUM NUMBER OF EXITS FOR OCCUPANT LOAD (TABLE 1019.1)	3 EXITS REQUIRED; 3 EXITS PROVIDED
501-1,000 OCCUPANTS	
ASSEMBLY MAIN EXIT - PROVIDED, 6 FT DOUBLE DOOR LEADING BUILDING MAIN EXIT WHICH LEADS TO A STREET PROVIDED WIDTH IS SUFFICIENT TO ACCOMMODATE MORE THAN HALF THE TOTAL OCCUPANT LOAD OF THE SPACE.	
PLUMBING FIXTURES (OSCC 2902)	
GROUP E OCCUPANCY PER TABLE 29-A	
SCHOOLS - STAFF USE 20 OCCUPANTS	
W/C LOAD	1/1
M/F: 10/10	
SCHOOLS - ELEMENTARY 10,229 SF / 50 SF/OCC = 205 OCCUPANTS	
W/C LOAD	1/1
M/F: 103/103	
PROVIDED:	
W/C	5 MEN'S
W/C	6 MEN'S
W/C	5 WOMEN'S
W/C	6 WOMEN'S
UNISEX	2 UNISEX
UNISEX	2 UNISEX
DRINKING FOUNTAINS RECD 1	
DRINKING FOUNTAINS PROVIDED 1 HC & 2 STANDARD	

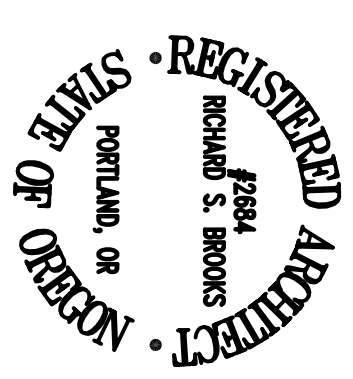

ISSUED DATE

CIDA
ARCHITECTURE
ENGINEERING
PLANNING
INTERIORS
LANDSCAPE

15895 SW 72ND AVE SUITE 200
PORTLAND, OREGON 97224
TEL: 503.228.1285
FAX: 503.228.1289
WWW.CIDA-INC.COM

TENANT IMPROVEMENT FOR
MITCH CHARTER SCHOOL
19550 SW 90TH COURT
TUALATIN, OREGON 97062

FLS1
FIRE, LIFE SAFETY
CODE SUMMARY