



ENVIRONMENTAL CONSULTING

August 31, 2023

Mrs. Caitlin Blood  
MITCH Charter School  
19550 SW 90<sup>th</sup> Court  
Tualatin, Oregon 97062

## **RADON TESTING AT MITCH CHARTER SCHOOL IN TUALATIN OREGON**

Dear Mrs. Blood:

At your request Apex Environmental collected samples for radon analysis at MITCH Charter School located at 19550 SW 90<sup>th</sup> Court. in Tualatin, Oregon. These samples were collected for a period of approximately 72 hours using activated carbon short term kits. Short term radon test kits measure radon over a period of 2-4 days. The short-term kits utilize a container that contains a quantity of granular activated charcoal. The charcoal absorbs the radon gas entering the container from the surrounding air. At the end of the testing period the container was sealed and set to Air Chek, Inc. for analysis. Radon levels reported by Air Chek were below the EPA corrective action recommendations (see attached table). Based upon these results follow-up testing or corrective action would not be required.

All testing was performed in accordance with the ANSI Protocol for Conducting Measurements of Radon Decay Products in Schools and Large Buildings (copyright 2015). Locations for testing were determined by Apex Environmental in collaboration with MITCH Charter School. Duplicate tests were performed at a rate of 10% in order to determine the reproducibility of the test and laboratory analysis. Field blank tests were taken at a rate of 5%. Blanks are used to determine if the test kits have been contaminated during storage in order to maintain efficiency.

The US EPA action level for indoor radon is 4.0 pCi/L. The EPA indicates that there is little short-term risk, with test results all under the detection level of 1.4 pCi/L. However, because radon levels fluctuate daily, as well as seasonally, you may want to retest during another season. Radon levels fluctuate so short-term test results may not be indicative of the true long-term average. Additionally, if you make any structural changes or start to use a lower level of the building more frequently, you should test again.

Mrs. Caitlin Blood  
RE: MITCH Charter School  
August 31, 2023  
Page 2 of 2

If you have any questions or need anything further, please feel free to call me.

Sincerely,

*Jose Godínez*

Jose Godinez  
Radon Measurement Technician

Attachments:   Radon Results  
                      Spike Results

**P8834 / TULLA STOCKER / APEX ENVIRONMENTAL**

Kit Number	Start Date	Start Time	End Date	End Time	Temp.	Facility	Building	Room	Project ID	Floor	Result
7396864	2023-08-19	6:00 pm	2023-08-22	12:00 pm	70	MITCH		27		1	1.0
7396865	2023-08-23	1:00 pm	2023-08-25	2:00 pm	70	MITCH		COMMONS WEST		1	24.5
7396866	2023-08-19	6:00 pm	2023-08-22	12:00 pm	70	MITCH		28		1	0.9
7396867	2023-08-19	6:00 pm	2023-08-22	12:00 pm	70	MITCH		29		1	< 0.3
7396868	2023-08-19	6:00 pm	2023-08-22	12:00 pm	70	MITCH		33 MIDDLE		1	1.0
7396869	2023-08-19	6:00 pm	2023-08-22	12:00 pm	70	MITCH		33 MIDDLE		1	1.0
7396870	2023-08-19	6:00 pm	2023-08-22	12:00 pm	70	MITCH		33 SOUTH		1	< 0.3
7396871	2023-08-19	6:00 pm	2023-08-22	12:00 pm	70	MITCH		33 NORTH		1	< 0.3
7396872	2023-08-19	6:00 pm	2023-08-22	12:00 pm	70	MITCH		31 NORTH		1	1.3
7396873	2023-08-19	6:00 pm	2023-08-22	12:00 pm	70	MITCH		31 MIDDLE		1	1.2
7396874	2023-08-19	6:00 pm	2023-08-22	12:00 pm	70	MITCH		31 SOUTH		1	1.0
7396875	2023-08-19	6:00 pm	2023-08-22	12:00 pm	70	MITCH		731 EAST		1	0.9
7396876	2023-08-19	6:00 pm	2023-08-22	12:00 pm	70	MITCH		731 WEST		1	< 0.3
7396877	2023-08-19	6:00 pm	2023-08-22	12:00 pm	70	MITCH		49 EAST		1	< 0.3
7396878	2023-08-19	6:00 pm	2023-08-22	12:00 pm	70	MITCH		45		1	< 0.3
7396879	2023-08-19	6:00 pm	2023-08-22	12:00 pm	70	MITCH		46 WEST		1	1.4
7396880	2023-08-19	6:00 pm	2023-08-22	12:00 pm	70	MITCH		46 MIDDLE		1	< 0.3
7396881	2023-08-19	6:00 pm	2023-08-22	12:00 pm	70	MITCH		55		1	< 0.3
7396882	2023-08-19	6:00 pm	2023-08-22	12:00 pm	70	MITCH		55		1	1.0
7396883	2023-08-19	6:00 pm	2023-08-22	12:00 pm	70	MITCH		49 EAST		1	1.2
7396884	2023-08-19	6:00 pm	2023-08-22	12:00 pm	70	MITCH		49 WEST		1	0.7
7396885	2023-08-19	6:00 pm	2023-08-22	12:00 pm	70	MITCH		46 EAST		1	< 0.3
7396887	2023-08-19	6:00 pm	2023-08-22	12:00 pm	70	MITCH		ART		2	0.8
7396889	2023-08-19	6:00 pm	2023-08-22	12:00 pm	70	MITCH		RECEPTION		1	< 0.3
7396890	2023-08-23	1:00 pm	2023-08-25	2:00 pm	70	MITCH		COMMONS EAST		1	23.5
7396891	2023-08-23	1:00 pm	2023-08-25	2:00 pm	70	MITCH		COMMONS MIDDLE		1	24.3
7396892	2023-08-19	6:00 pm	2023-08-22	12:00 pm	70	MITCH		COUNSELOR		2	< 0.3

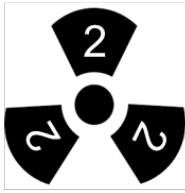

# Radon Chamber

## Kansas State University

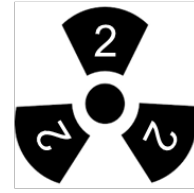

KSU Radon Chamber

NRPP Certification ID Number SC-1006



Date:8/25/23

Jose Godinez  
Apex Environmental  
12950 SW Westfall Rd., Sherwood, OR 97140  
[Godinezjosee@gmail.com](mailto:Godinezjosee@gmail.com)  
971-272-7776

These are the results of the spiking that we performed on the device(s) listed below:

Device Serial #	Start Date	Start Time	Stop Date	Stop Time	Chamber Value *
7396891	8/23/23	13:10	8/25/23	14:25	23.6 pCi/L
7396865	8/23/23	13:10	8/25/23	14:25	23.6 pCi/L
7396890	8/23/23	13:10	8/25/23	14:25	23.6 pCi/L

**These devices were spiked in our chamber at an average relative humidity of avg/rh 33.7%.  
These devices were spiked in our chamber at a chamber temperature of 73.7°F.  
This chamber is at an elevation of approximately 1020 feet.**

The additional information below is provided as a service for our customers who have furnished KSU Radon Chamber with the customer's measured values for the above devices. This equation calculates the difference between our chamber value and the customer's measured value and is called the percent error. It is calculated as follows:

$$\% \text{ Error} = \frac{\text{Measured Value} - \text{Chamber Value}}{\text{Chamber Value}} * 100$$

**Measured Value:** pCi/L      **Chamber Value:** pCi/L      **Error:**

Thank you for your patronage. If we can be of further help, please email us at [radonchamber@ksu.edu](mailto:radonchamber@ksu.edu) or call us at (785-532-4992).

Sincerely,

Alexandra Bahadori

# ARCHITECT

CONTACT: MYA PALUCH

ADDRESS: 19450 SW 90TH  
 TOTAL OCCUPANTS: 1,302 OCCUPANTS 4 EXITS REQUIRED  
 5 EXITS PROVIDED

## Upstairs

7396892 (counselors office)  
 7396887 (art room)

## Blanks

7396881 (55)  
 7396882 (55)

## Spikes

7396865 (commons W)  
 7396890 (commons E)  
 7396891 (commons M)

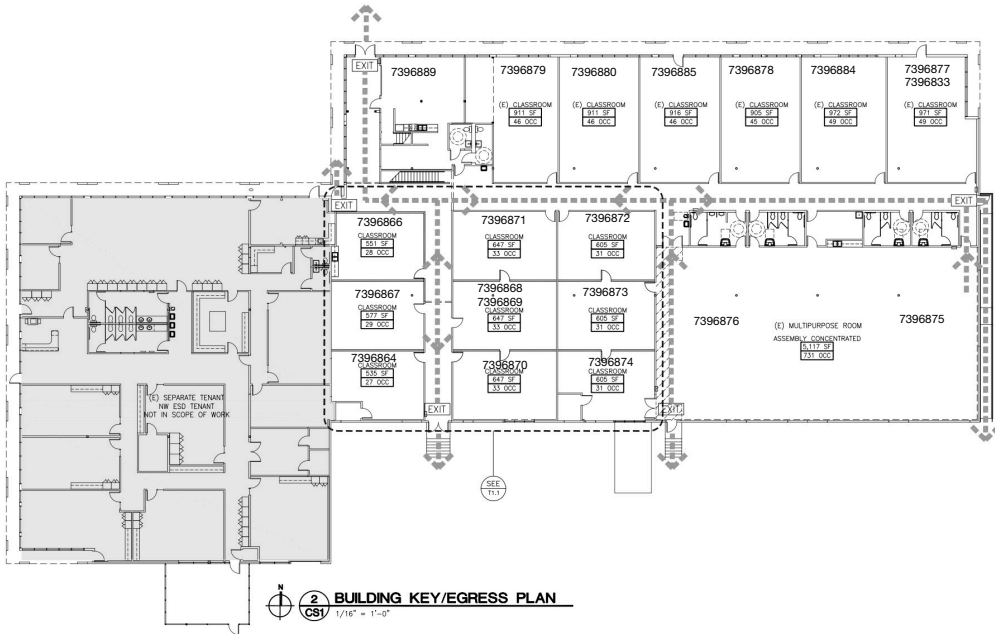

**2** BUILDING KEY/EGRESS PLAN  
 CS1 1/16" = 1'-0"



15895 SW 73RD AVE SUITE 200  
 PORTLAND, OREGON 97224  
 TEL: 503.226.1283  
 FAX: 503.226.1670  
 WWW.CIDAINC.COM

TENANT IMPROVEMENT FOR:  
**MITCH CHARTER SCHOOL**  
 19550 SW 90TH COURT  
 TUALATIN, OREGON 97062